

Orbital Flex™ Design

ML2000



KEY FEATURES

- High Torque
- High Rigidity
- High Positional Accuracy
- Linear Torsional Stiffness
- Cross Roller Output Bearing

All of this, while maintaining zero backlash for 10,000 hours at rated loads!

	ML2000-86-60	ML2000-75-100	ML2000-86-100	ML2000-97-100	ML2000-120-100
Availability	Now	Q4 2024	Q2 2024	Q3 2024	2025
Outer Diameter	86	75	86	97	120
Ratio	60:1	100:1	100:1	100:1	100:1
Rated Output Torque	45 Nm	20 Nm	65 Nm	130 Nm	270 Nm
Repeatable Peak Output Torque **	75 Nm	35 Nm	90 Nm	195 Nm	400 Nm
Rated Input Speed **	2000 RPM	2000 RPM	2000 RPM	2000 RPM	2000 RPM
Repeatable Peak Input Speed **	4000 RPM	4000 RPM	4000 RPM	4000 RPM	4000 RPM
Efficiency **	64 %	Coming Soon	Coming Soon	Coming Soon	Coming Soon
Backlash **	0 Arcsec	0 Arcsec	0 Arcsec	0 Arcsec	0 Arcsec
Positional Accuracy (one way)	2 Arcmin	3 Arcmin	2 Arcmin	2 Arcmin	2 Arcmin
Torsional Stiffness	7 Nm/Arcmin	4 Nm/Arcmin	7 Nm/Arcmin	15 Nm/Arcmin	30 Nm/Arcmin
Noise ***	<70 dB	<70 dB	<70 dB	<70 dB	<70 dB

** Under defined conditions *** Rated speed in ambient room

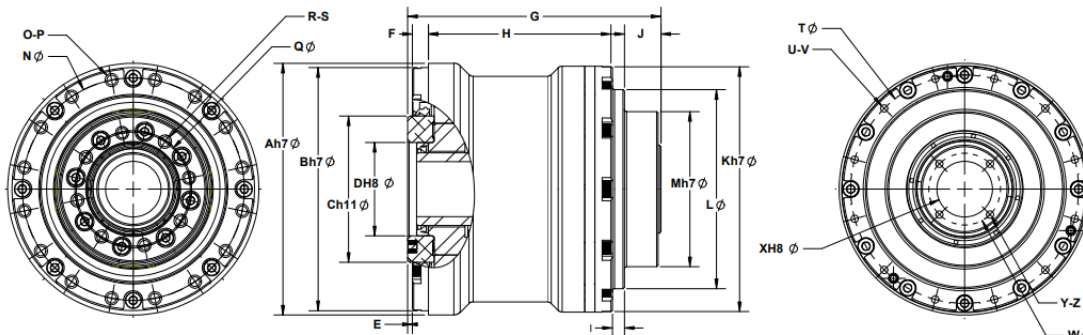

ML2000	Mass	A	B _{h7}	C _{h11}	D _{H8}	E	F	G	H	I	J	K _{h7}	L _{h7}	M	N	O	P	Q	R	S	T	U	V	W	X _{H8}	Y	Z		
86-60	1500	86	83	50	32	1.6	5.5	87.1	63.37	4.13	12.5	84	68	53	76	M4x0.7	φ4.5x7.5	16	39	M4x7.0	φ4.5x9.1	8	78	M3x0.5	12	24.5	19	M3x0.5	4
75-100	1000	75	73	40	23	0.5	5.5	69.9	52.089	3	10	75	60	47.5	66	M4x0.7	φ4.5x13.5	16	30	M3x0.5	φ3.5x10.5	8	69	M3x0.5	12	20	14	M3x0.5	4
86-100	1300	86	83	50	32	1.6	5.5	74.1	50.27	4.13	12.5	84	68	53	76	M4x0.7	φ4.5x7.5	16	39	M4x7.0	φ4.5x9.1	8	78	M3x0.5	12	24.5	19	M3x0.5	4
97-100	1900	97	94	60	32	0	7	87	63.066	2.91	14	97	82	60	86	M4x0.7	φ4.5x15.0	16	42	M4x7.0	φ4.5x15.0	8	91	M3x0.5	16	25	21	M3x0.5	4
115-100	4600	115														In Design - TBD													